



# DALI Cockpit Mobile Smartphone Application

## Overview

The screenshot shows the app interface for 'Office 1'. At the top right, there is a Bluetooth icon. Below it, the title 'Office 1' is displayed. The main area contains three control widgets: 'on presentation', 'on accent lighting', and 'on dim up - task light'. Below these are three horizontal sliders for 'accent lighting', 'meeting room', and another 'meeting room'. At the bottom, there are two buttons: 'Control' and 'Configuration'. To the right of the phone, there are icons for Wi-Fi and Bluetooth. Orange callout boxes provide the following information:

- click to view all Bluetooth Room Controller devices in the surrounding area (pointing to the Bluetooth icon)
- control page with control elements (widgets) (pointing to the main control area)
- the name of the currently connected BT5 Room Controller is displayed here (pointing to 'Office 1')
- Link to the control page (pointing to the 'Control' button)
- Link to the configuration page (pointing to the 'Configuration' button)



DALI-Cockpit/Mobile App - Google Store Download

<https://play.google.com/store/apps/developer?id=Lunatone+Industrielle+Elektronik+GmbH&hl=de>



DALI-Cockpit/Mobile App - Appstore Download

<https://apps.apple.com/de/developer/lunatone/id624497126>

The DALI Cockpit Mobile App currently supports the configuration of the following devices:

Operating devices / Control gear:

- DALI Dimmers– standard DALI settings of DALI gears (by Lunatone or other manufacturers)
- DALI Jalousie modules (Art. Nr.: 86458676)
- DALI Relay modules (Art. Nr.: 86458675, Art. Nr.: 86458629)

Sensors:

- DALI-2 CS (Art. Nr.: 86458670,  
Art. Nr.: 86457244,  
Art. Nr.: 88793325)
- DALI-2 LS (Art. Nr.: 68791433)

Controls:

- DALI-2 Touchpanel (Art. Nr.: 24035410)
- DALI-2 Switch Cross (Art. Nr.: 86459793-*colourcode-2*)
- DALI-2 MC (Art. Nr.: 86459532-2)
- DALI-2 MC4L (Art. Nr.: 86458507-4L-2)
- DALI-2 Rotary (Art. Nr.: 86459822,  
Art. Nr.: 86459822-TW,  
Art. Nr.: 86459822-RGB,  
Art. Nr.: 86459822-RGBW)

further control devices:

- DALI CDC (Art. Nr.: 89453853)
- DALI RTC (Art. Nr.: 86459531)
- DALI-2 Sequencer (Art. Nr.: 89453371)

Start Screen

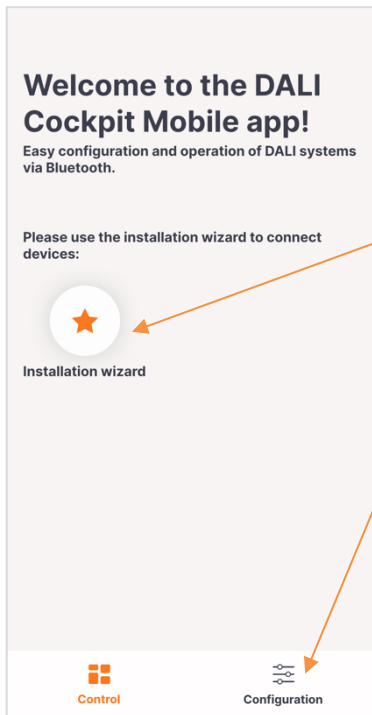

When opening the DALI Cockpit Mobile for the first time, the **start screen** appears.

Click on "**Installation Wizard**" to connect devices.

Or switch to the **configuration menu** to connect to a previously added Room Controller.

Installation assistant – load and address DALI systems in 4 steps

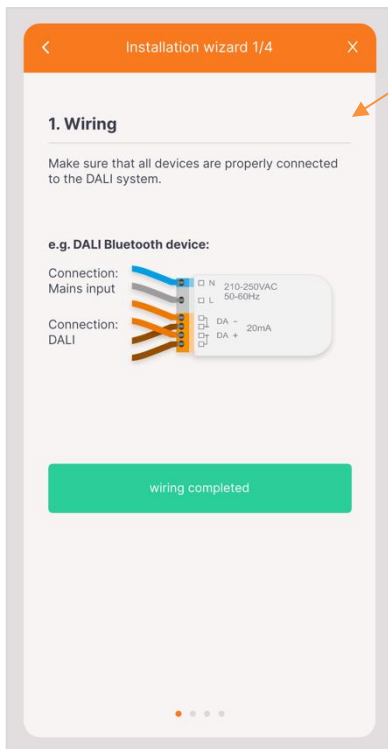

Step 1 of 4:

For a new installation: Make sure that you have connected all devices correctly, then click on "successfully wired" to continue

Step 2 of 4:

Select the DALI-2 Room Controller module you would like to connect to.

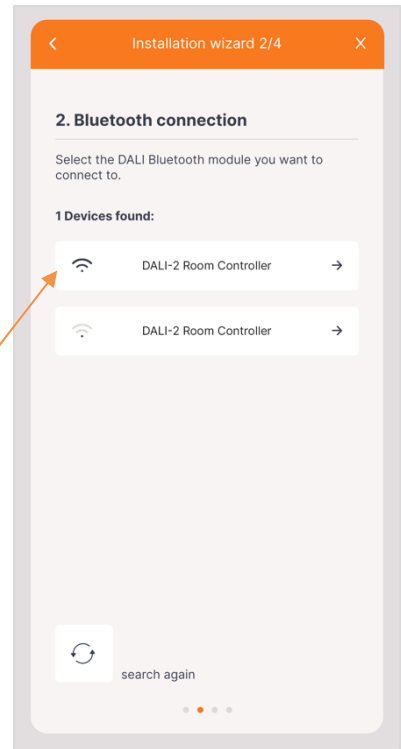

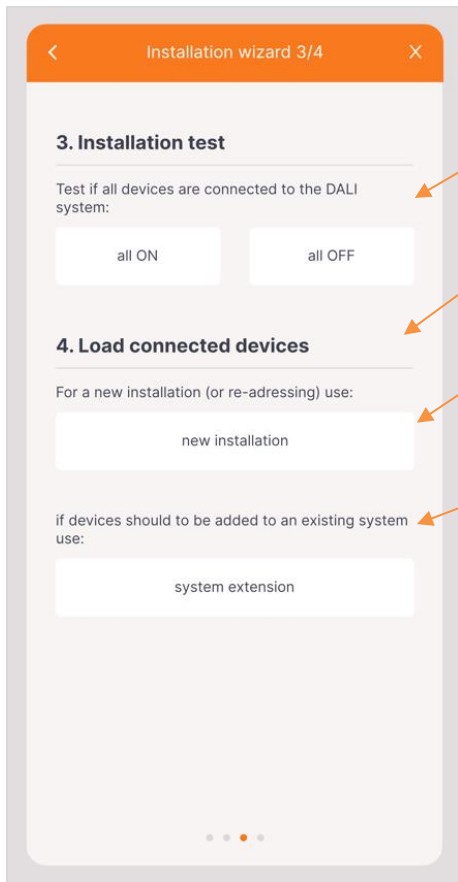

Step 3 of 4:

**Function test** to confirm the connection of all connected luminaires by switching them on and off, before starting the addressing process.

**Select which type of addressing process should be used:**

- **"New installation"** – use if addressing has never been carried out or to newly set up a system.  
**Attention: existing addresses are deleted and reassigned**
- **"System expansion"** – use if devices are to be added to an existing DALI system, all existing, already integrated devices keep their addresses

After clicking the button, the addressing process will begin. Reading out the bus can take some time, please be patient until all devices are found and addressed.

Step 4 of 4:

The number of found and addressed devices will be displayed.

With the selection **"Control elements"**, basic widgets for the control page are automatically created to control the found devices.

To finish the installation process, click "complete installation & open configuration menu". The configuration page with links to all the devices' configuration menus will be displayed.

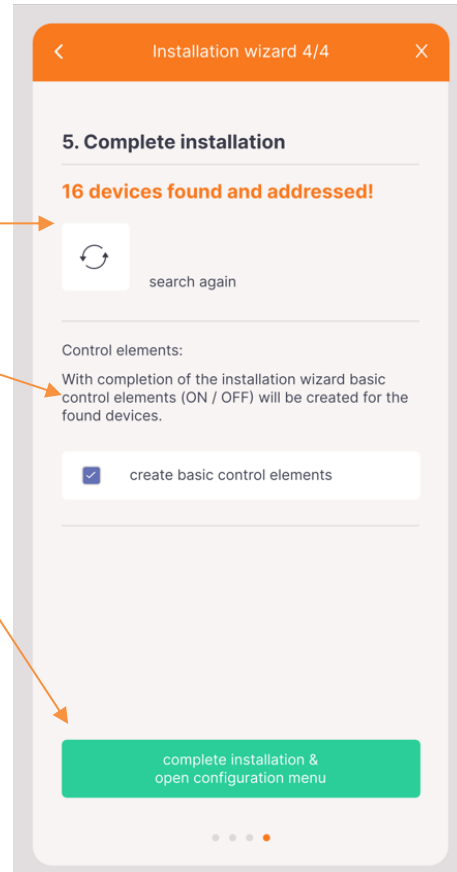

Configuration page - Overview

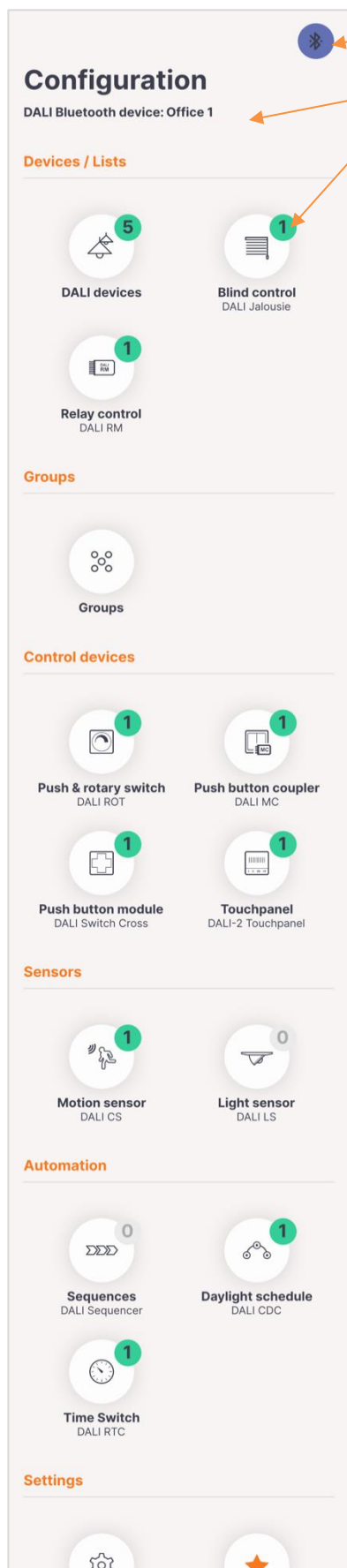

Select Bluetooth connection - here you can switch to other DALI-2 Bluetooth Room controllers  
 Displays the name of the currently connected Bluetooth device  
 in the green circles the number of connected devices of the respective device type is displayed

Overview of the settings in the submenus:

Devices / Lists

**DALI devices** p.9  
 Name, basic settings, system failure level, group membership, (calibration)

**Blind control** p.11  
 Settings for up to 4 DALI blind modules:  
 assign groups, set duration of a complete run, time for slat tilting

**Relay control** p.10  
 Settings for DALI RM modules:  
 Name, basic settings, system failure level, group membership, threshold values

**Groups** p.11  
 Assign devices to a group

**Control devices**  
**Push & rotary switch – DALI-2 ROT** p.12  
 Name, effective range, operating mode, functions (pressing, rotation)

**Push button coupler – DALI-2 MC, DALI-2 MC4L** p.13  
 Settings for up to 4 buttons:  
 name, functions (short, long button press), effective range

**Push button module – DALI-2 Switch Cross** p.13  
 Settings for 4 buttons: functions (short, long button press), effective range

**DALI-2 Touchpanel**  
 Select layout, key functions (short, long key press), effective range (keys, sliders)

**Sensors**  
**Motion sensor - DALI-2 CS** p.14  
 Effective range, switch-on command, hold time, light level, second hold time, end command

**Light sensor - DALI-2 LS**  
 Effective range, operating mode (constant light control or threshold value)

**Automation**  
**Sequences - DALI Sequencer**  
 Create sequences: effective range, playback mode (single or loop), define sequence (time, fade time, scene)

**Daylight schedule - DALI CDC** p.16  
 change of light depending on daytime: different color temperature and brightness can be set for each hour

**Time switch - DALI RTC** p.15  
 Effective range, day selection, time stamp (daytime / relative to the position of the sun), function

Settings -> see next page

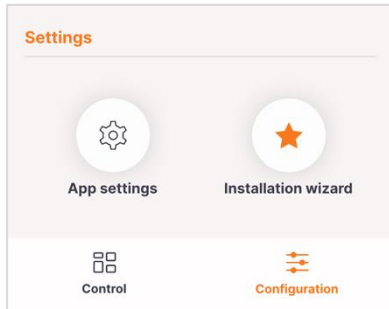

**Settings**

**App settings** p.16  
Language (German, English), access rights and user management

**Installation wizard** p.3  
Assistant for connecting and addressing devices

**Tab bar**

**Control** p.7  
link to the control page

**Configuration** p.6  
link to the configuration page

**Control page - Overview**

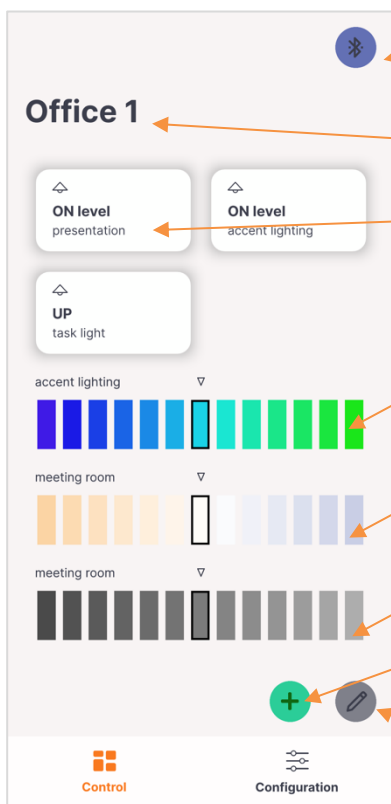

Bluetooth connection - here you can switch to other DALI-2 Bluetooth Room controllers

name of the connected **Bluetooth device**

Control element (widget): **button**  
function (e.g. ON level)  
Name (e.g. presentation)  
function for press and long press

Control element:  
**RGB slider**

Control element:  
**Tunable White CW-WW slider**

Control element: **brightness slider**

**Add control element**

**Edit control elements**

**Tab bar**

**Control** p.7  
link to the control page

**Configuration** p.6  
link to the configuration page

**Control page:** add a new control element

Select type of control element:

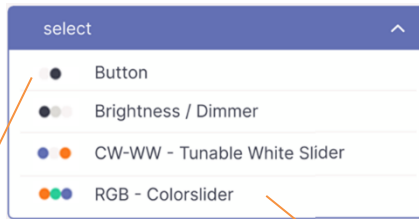

create button:

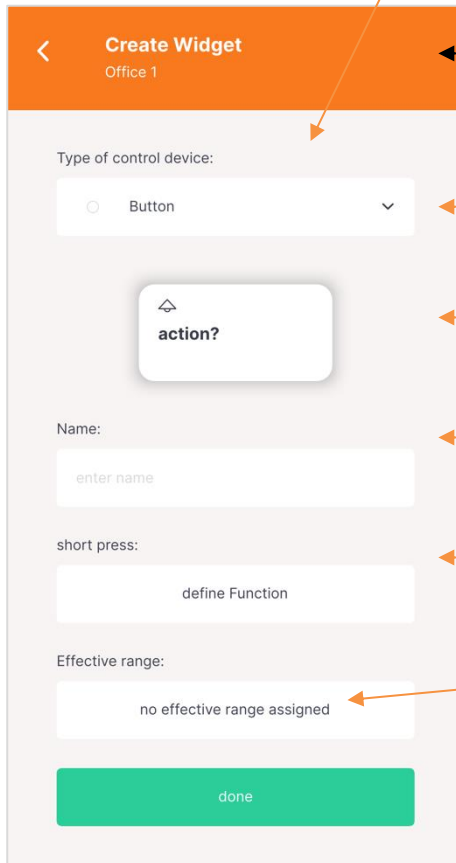

create RGB colour slider:

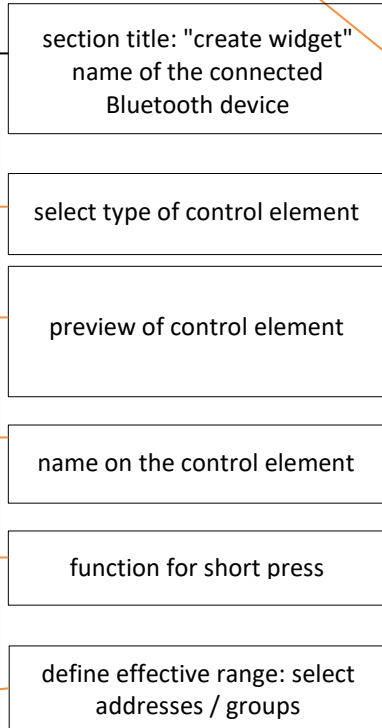

**Control page:** share widgets

The created widgets can be shared with other users via the "share" button on the user interface:

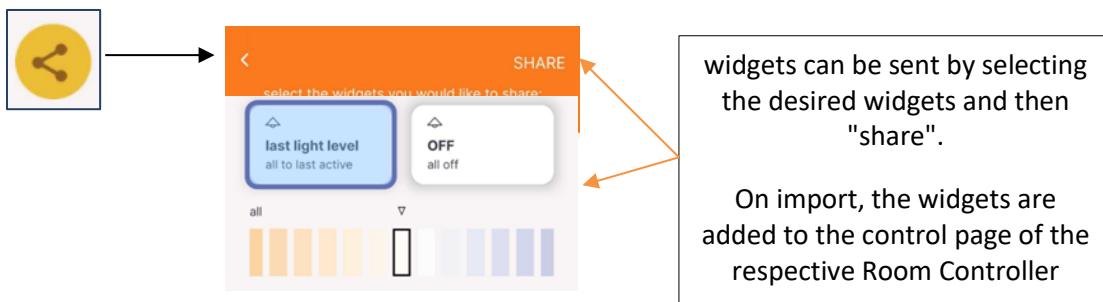



Configuration page: **Devices / Lists**: Overview of the DALI ballasts found

**Section title: "DALI devices"**  
name of the connected **Bluetooth device**

tab for each device, it shows the name of the device and assigned groups. When clicked the available settings appear.

**ON/OFF Button**

DALI address of the device

device name (app internal)

**Basic settings**  
MIN Level in %  
MAX Level in %  
Power ON Level in %  
Fade Time in seconds  
Fade Rate in steps / second

**System Failure Level**  
Device behaviour in the event of a system error:  
all lights off - 0%  
all lights on - 100%  
no change

**Group membership**  
click on the desired groups to assign it to the device

**Calibration**

- Calibration of 0.1% level for standard LED lights
- Calibration of CW-WW: Define max warm, max cold and neutral white
- Calibration of RGBW: define "white".

CW-WW - Calibrate warm and cold white:  
move the slider until the reproduced light matches the title:  
100% warm white  
100% cold white  
neutral white

RGBW: Calibrate white area:  
move the slider until your lamp glows "white":

Further devices (up to 64)

Configuration page: **Devices / Lists:** Relay Control

The screenshot shows the 'Relay control' configuration page for 'Office 1'. The page is divided into several sections:

- Section title:** "Relay control" name of the connected **Bluetooth device**
- tab for each device:** it shows the name of the device and assigned groups. When clicked the available settings appear.
- ON/OFF Button:** A button with a sun icon to toggle the device.
- DALI address of the device:** A field showing the current DALI address (A4).
- device name (app internal):** A text input field for a new name.
- Basic settings:** A section containing five sliders:
  - MIN Level: 0.9%
  - MAX Level: 7.5%
  - Power On Level: 8.8%
  - Fade Time: 8.0s
  - Fade Rate [steps/s]: 44.7
- System Failure Level:** A section with three radio button options: 0%, 100%, and No change.
- Group membership:** A grid of buttons labeled G1 through G15. G1 is highlighted in blue.
- Switching threshold:** A section with four sliders:
  - UP switch-ON threshold: 3.0%
  - DOWN switch-ON threshold: MASK
  - UP switch-OFF threshold: MASK
  - DOWN switch-OFF threshold: 1.7%

Configuration page: **Devices / Lists:** Blind control

**Blind control**  
Office 1

Information & help

A1 DALI Jalousie G1

Group membership

Sh... Lo... G2 G3

G4 G5 G6 G7

G8 G9 G10 G11

G12 G13 G14 G15

Blind control

complete run: 34,3 (min:s)

tilt slats: 40,0 sec

**Section title: "Blind control"**  
name of the connected **Bluetooth device**

tab for each device, it shows the name of the device and assigned groups. When clicked the available settings appear.

**Group membership**  
click on the desired groups to assign device

**Blind control**  
Define time for a complete run and for how long slats should be tilted.

Configuration page: **Groups:**

**Groups**  
Office 1

Information & help

**DALI groups**

With group commands whole areas can be switched and dimmed simultaneously. The DALI system supports up to 16 groups, each DALI device can belong to one or more groups.

G0: Shared space

Name: Shared space

Devices in this group: Luminary Office A, Luminary shared space

G1: Lounge area

section title: "DALI Groups"  
name of the connected Bluetooth device

tab for each group

Define the name of the group (app internal)

click button to assign devices to this group

ON / OFF switch (to test the entire group)

remove all assigned devices

further groups, 16 in total

Configuration page: **Control devices:** Push & rotary switch – DALI-2 ROT

possible operating modes displayed depending on the ROT device version:

- Nr.1 „I“ Intensity**  
 ON/OFF, DIM
- Nr.2: „TW“ Intensity & Tunable White**  
 ON/OFF, change mode, mode1 DIM, mode2 TW
- Nr.3: „RGB“ Intensity & RGB**  
 ON/OFF, change mode, mode1 DIM, mode2 RGB
- Nr.4: „RGBW“ Intensity & RGBW**  
 ON/OFF, change mode, mode1 DIM, mode2 RGB, mode3 W
- Nr.6: „BD/CD“ Balance&Dim / Colour&Dim**  
 ON/OFF, change mode, mode1 DIM, mode2 TW / RGB

**Configuration page: Control devices: Push button coupler – DALI-2 MC**

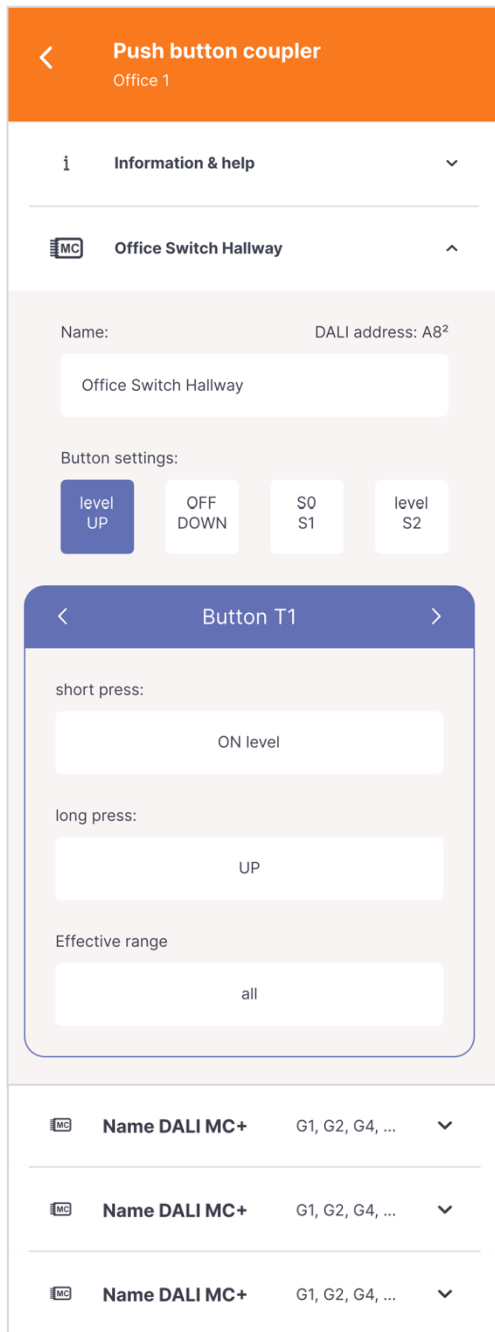

**Configuration page: Control devices: Push button module – DALI-2 Switch Cross**

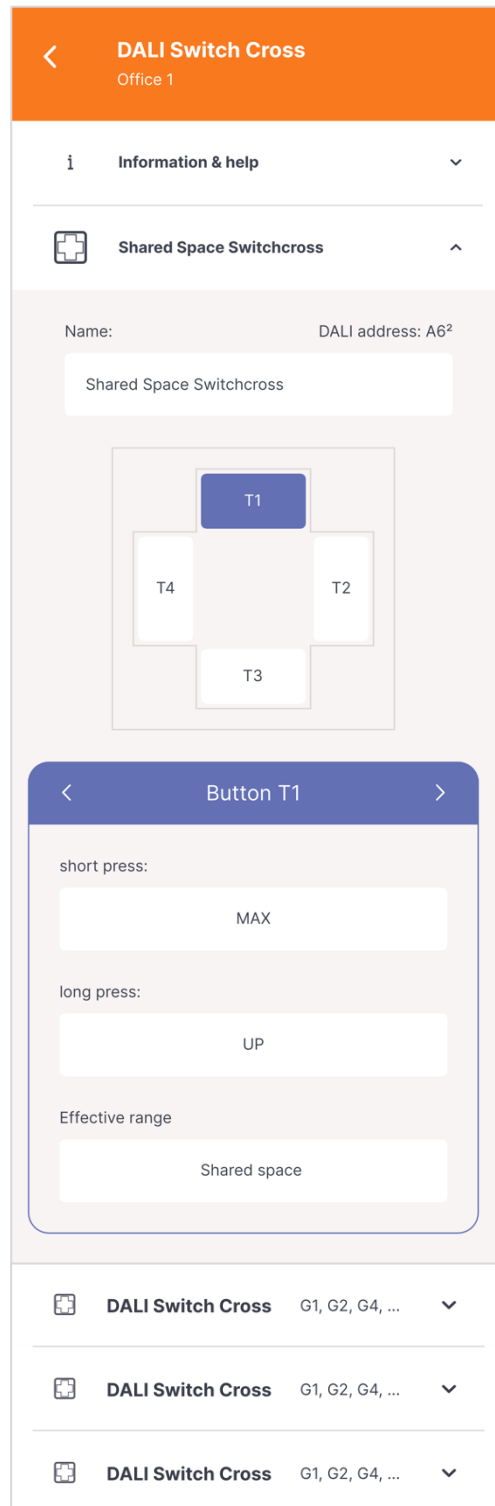

Configuration page: **Sensors:** Motion sensor - DALI CS

← **Motion sensor**  
Office 1

---

**i** Information & help
▼

---

**A0² CS** all
^

↻

measured LUX level

Name:

DALI address: A0²

Effective range:

Operating mode

Motion sensor

Constant light control

**Motion sensor**  
When motion is detected, a user-defined command is sent, the hold time and light level can then be defined:

←
1. ON command
→

Upon motion detection:

MAX

Constant light control

The lighting is kept constant at a defined LUX level by continuously measuring the overall light level and making small adjustments if necessary:

LUX level:

496 Lux

Operating mode

The motion detection is active when:

measured LUX level < threshold

measured LUX level > threshold

at any LUX level

Define light level and hold time:

←
2. Hold time
→

Duration (min:s):

▽  
△

←
3. decrease light level
→

Brightness

▽

Duration / Fade time:

▽  
△

←
4. second Hold time
→

Duration (min:s):

▽  
△

←
5. End command
→

Command to end process:

OFF

Configuration page: Automation: Time switch - DALI RTC

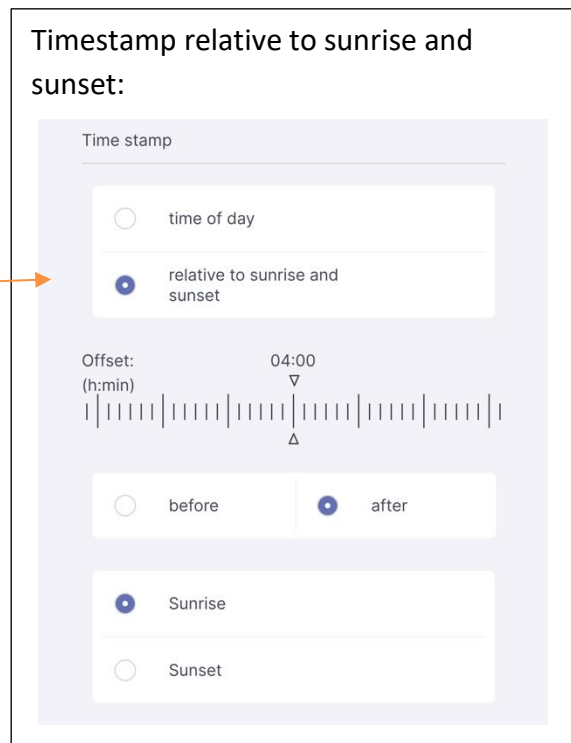
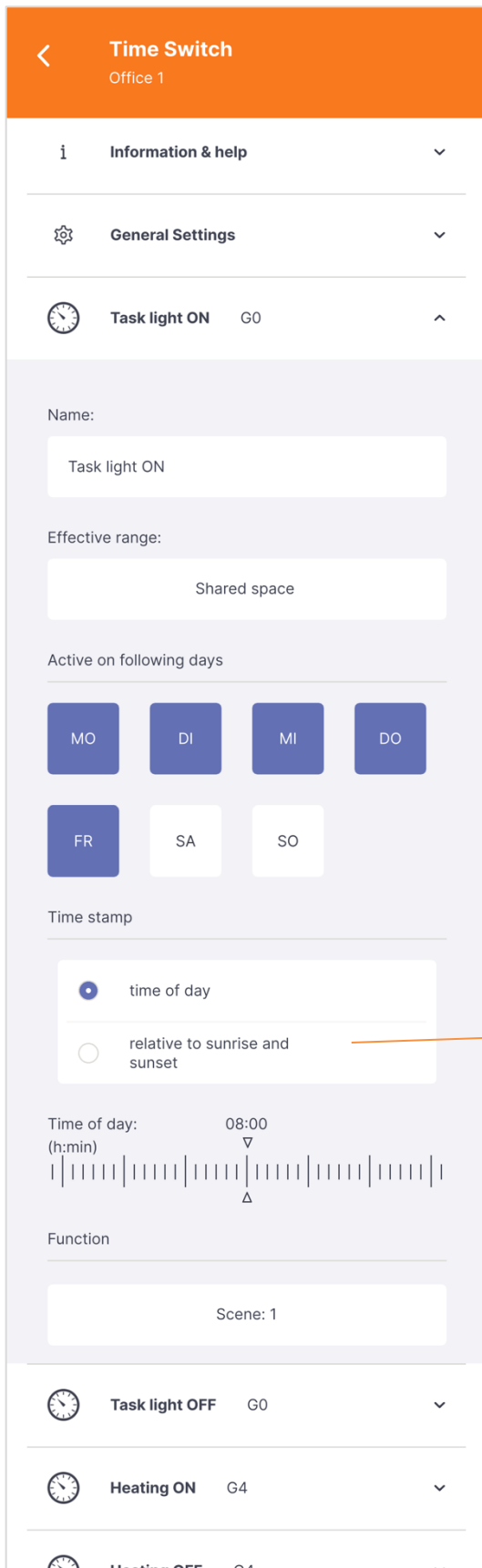

up to 28 entries

**Configuration page: Automation:**  
Circadian Daylight Schedule - DALI CDC

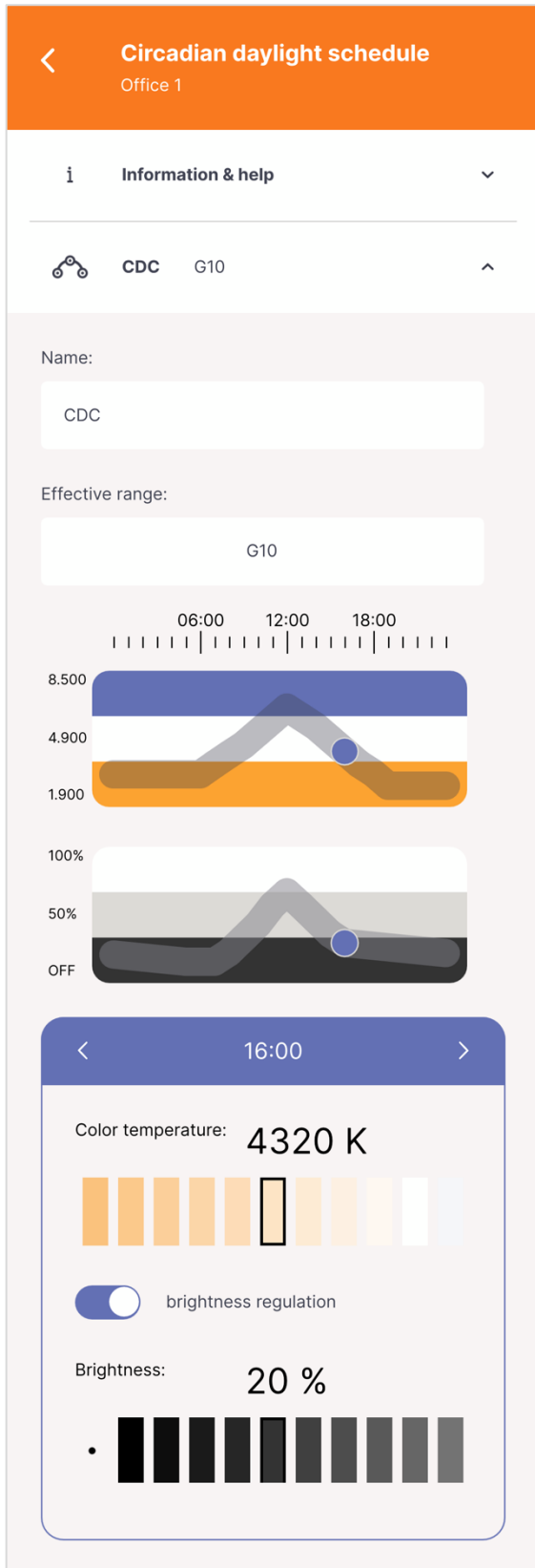

**Configuration page: App Settings:**  
General Settings

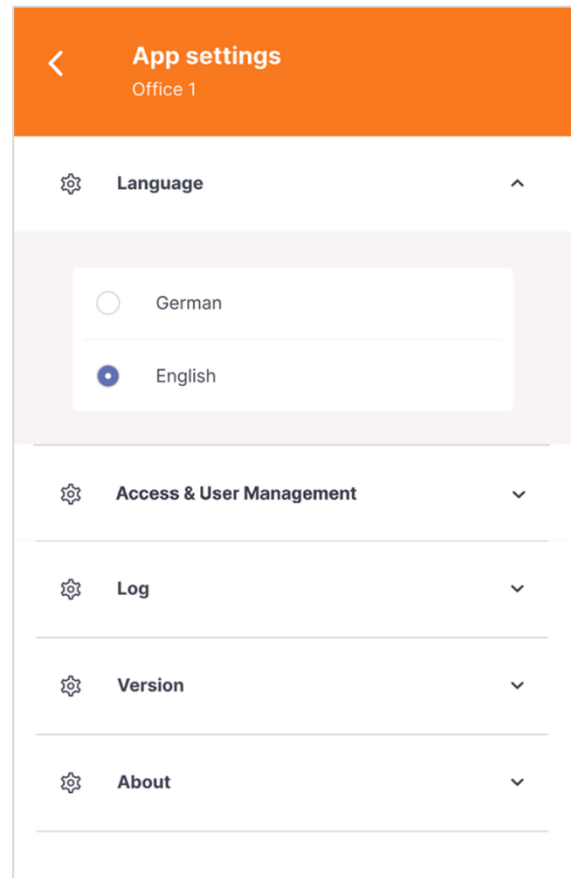

**Configuration-page: Firmware Updates**

The firmware of the DALI Room Controller can be loaded under **Settings: Version**. After loading the firmware, it is necessary to re-connect to the DALI Room Controller.

**Attention:** do not disconnect or interrupt the Bluetooth connection during the firmware update!

**Info:** The latest firmware version of the DALI Room Controller may not be compatible with old app versions. If you have problems with the connection, please download the latest app.



**Configuration-page: User Management**

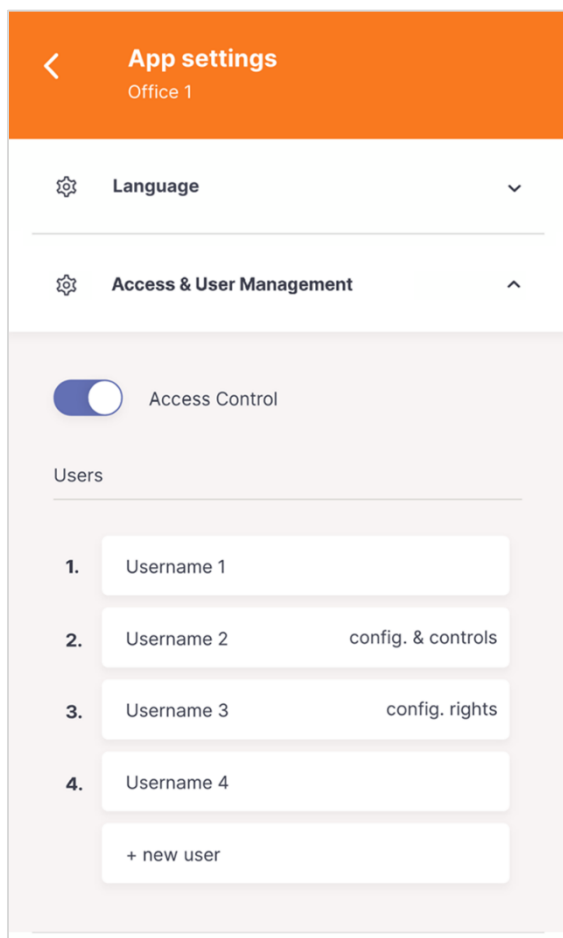

The access and user management is from app version 1.6 and Room Controller firmware version 1.12. available

The user management can be found using the button on the control-page



or accessed via the settings page.

When the user access management is activated, the DALI Room Controller checks whether the devices trying to establish a connection are registered users; if not, the connection is not permitted.

**Activate the Access & User Management**

The user management can be activated using the slider.

The phone with which the user management is activated automatically becomes the administrator.

Additional users with administrator rights can then be created.

**Creating a user**

Up to 50 users can be created.

Users can be created with different rights. The following user rights are available::

- no rights
- control rights
- control and configuration rights
- administrator

The permissions granted with the respective rights are listed in the table below (see page 18).

After the user has been created, it needs to be shared with the respective user: by selecting: "Share user".

Another page opens for the selection of widgets which can be shared additionally with the user.

By selecting "Share" the user (and widgets, if applicable) can be sent to the respective user.

Die zugesendete Datei kann von dem Benutzer über die App geöffnet werden, dieses Telefon wird bei der nächsten Verbindung mit dem Room Controller als der Benutzer registriert.

By opening the file with the Cockpit Mobile app, that phone will be registered as the shared user, the next time it is connected to the respective Room Controller.

	user	user with control-rights	user with control- and configuration rights	administrator
using shared widgets	✓	✓	✓	✓
create and edit widgets	-	✓	✓	✓
configuration-page – edit device configuration	-	-	✓	✓
DALI installation-wizard	-	-	✓	✓
basic settings: language, units, about	✓	✓	✓	✓
rename DALI Room Controller	-	-	✓	✓
version + firmware update	-	-	✓	✓
user management: create and edit users	-	-	-	✓

### Edit a user

User rights can be extended or removed by an administrator at any time, an active connection to the Room Controller is necessary.

**Attention:** widgets that have already been shared cannot be retrieved and must be deleted by users themselves.

Users can also be deleted. However, an administrator cannot delete himself, only by another administrator.

### Troubleshooting when losing access

If the administrator phone is no longer available and there are no other administrators, access can be reactivated using the button on the Room Controller.

**step 1:** press and hold the button on the device for more than 10 seconds (LED on the device lights up continuously)

**step 2:** connect to the Room Controller via the app.

**step 3:** activate the user management manually in the app. The activation adds the phone as an administrator.

If after step 1, steps 2 and 3 do not follow within the next minute, the original user administration becomes active again.

### Contact

Technical Support: [support@lunatone.com](mailto:support@lunatone.com)

Requests: [sales@lunatone.com](mailto:sales@lunatone.com)

[www.lunatone.com](http://www.lunatone.com)

### Disclaimer

Subject to change. Information provided without guarantee. The datasheet refers to the current delivery.

The function in installations with other devices must be tested for compatibility in advance